

BV12F5N/2000

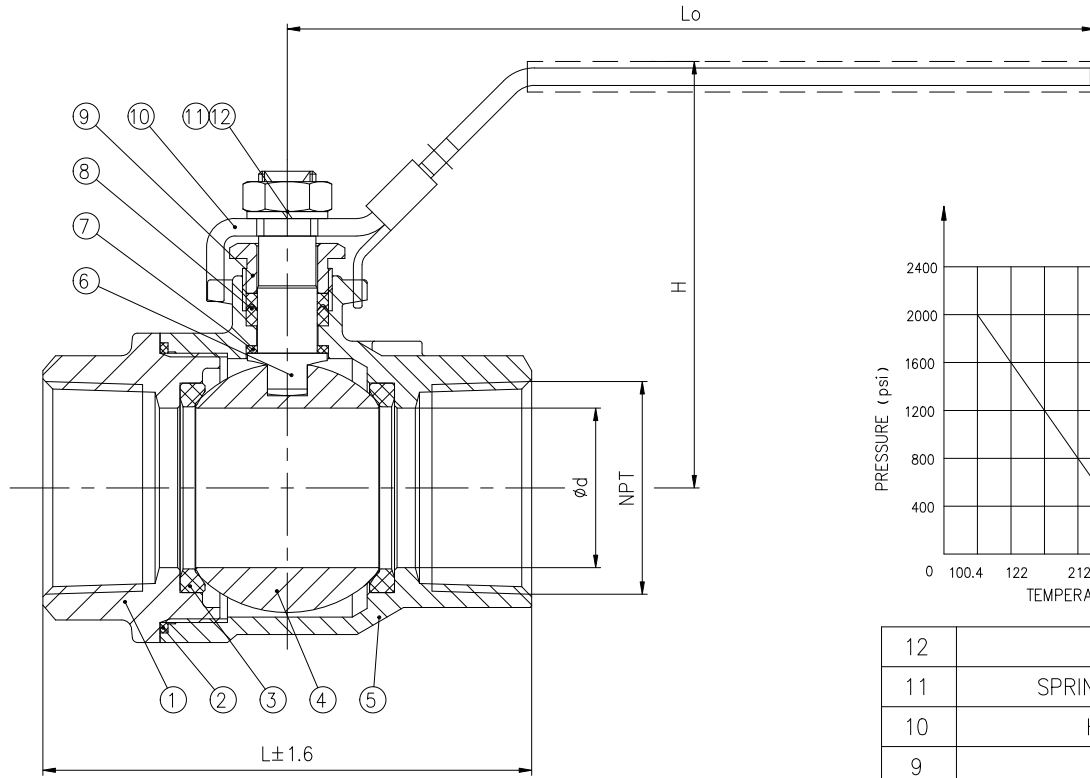

Nominal pressure			2000Psi				
Test pressure	Shell test	20.7	Mpa	Test medium	Water	Test temperature	Normal temperature
	Seal test	15.2			Air		
	Gas seal test	0.6					
Applicable medium			Water,Oil,Gas				
Applicable temperature			-20~302F				

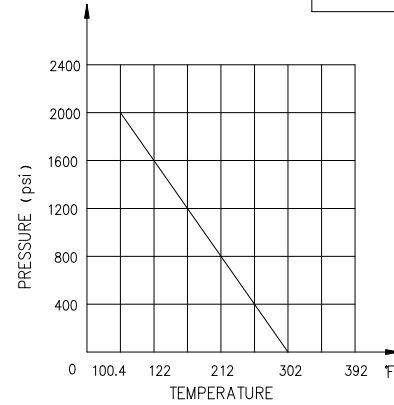

NOTE:
 1.Design and Manufacture for valve according to ASME B16.34.
 2.Inspection and Test for valve according to API 598.
 3.The connection of screwed for valve according to ANSI B1.20.1.

NPS	L	d	NPT	Lo	H	Weight (lb)
1/4"	2.205	0.433	1/4"	3.740	1.909	0.518
3/8"	2.205	0.453	3/8"	3.740	1.909	0.474
1/2"	2.480	0.591	1/2"	4.134	2.106	0.661
3/4"	2.874	0.768	3/4"	4.724	2.579	1.047
1"	3.307	0.984	1"	5.512	2.815	1.598
1 1/4"	3.858	1.260	1 1/4"	5.906	3.169	2.513
1 1/2"	4.139	1.496	1 1/2"	7.756	3.819	3.516
2"	4.724	1.929	2"	7.283	4.488	5.082
2 1/2"	5.984	2.520	2 1/2"	8.661	4.646	-
3"	6.713	3.301	3"	10.623	5.295	-
4"	8.031	3.898	4"	12.402	6.109	-

12	NUT	1	A194 8
11	SPRING WASHER	1	304
10	HANDLE	1	STAINLESS STEEL
9	GLAND	1	304
8	PACKING	1	PTFE
7	STEM WASHER	1	PTFE
6	STEM	1	A276 316
5	BODY	1	A216 WCB
4	BALL	1	SS316
3	SEAT	2	PTFE
2	GASKET	1	PTFE
1	BONNET	1	A216 WCB
NO.	DESCRIPTION	Q'TY	MATERIAL

				ANIX VALVE USA	
				2PC Ball Valve 2000PSI,NPT	
				BV12F5N/2000	
				SCALE	
MARK	BEFORE MODIFIED	AFTER MODIFIED	DATE		
DRA.		APP.			
CHK.		DATE			